

# DRNV-100

Rotary,  
Flow Control

## SERIES 10

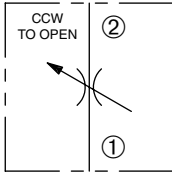

### DESCRIPTION

A cartridge valve designed to provide variable flow restriction in both directions.

### OPERATION

The DRNV-100 varies flow restriction by adjusting spool open or closed. Flow is metered from ① to ② and ② to ①.

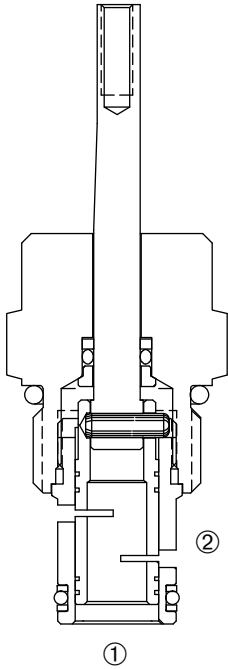

### FEATURES and BENEFITS

- Hardened spool and sleeve for long life.
- Industry common cavity.
- Compact size.

### SPECIFICATIONS

**Operating Pressure:** 3000 PSI (207 Bar)

**Max. Flow:** 6 gpm (23 l/min)  
9 gpm (34 l/min)  
12 gpm (45 l/min)

**Internal Leakage:** 82 cc/min at 3000 PSI (207 Bar)

**Temperature:** -30°F to +250°F (-35°C to +120°C).

**Recommended Filtration:** ISO 17/15/13

**Fluids:** Mineral-based fluids.

**Cavity/Cavity Tool:** 100-2, see page 11.10.2

**In-Line Body Material:** Anodized 6061T6 aluminum alloy rated at 3000 PSI (207 Bar).

### PRESSURE DROP VS. FLOW

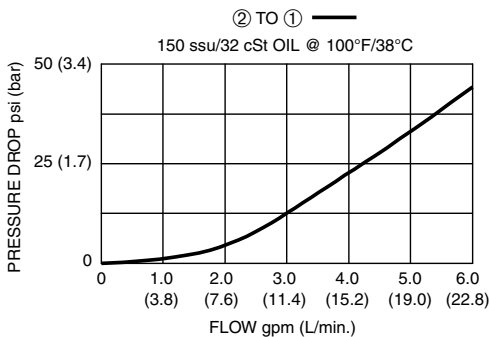

## INSTALLATION DIMENSIONS

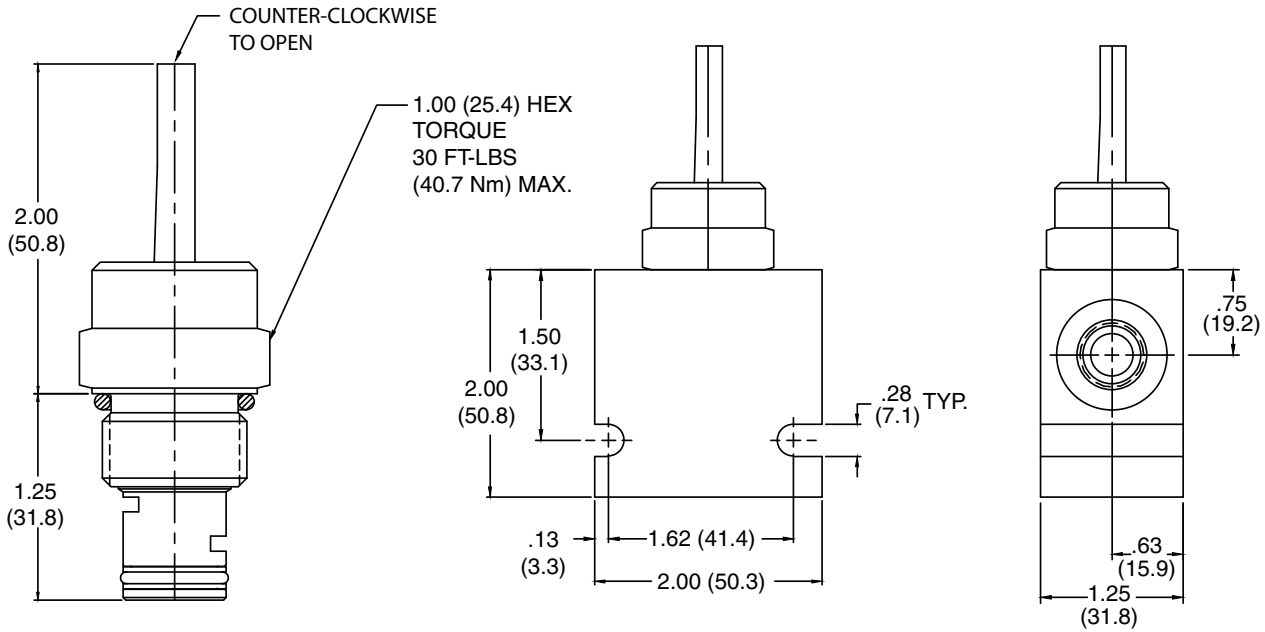

( ) Parentheses = Millimeters

## HOW TO ORDER

